

THERMATEC

THERMAL SPRAY DIVISION OF AMERICAN TORCH TIP

BAYSTATE[®]
EUTECTIC[®]
GTV[®]
METCO[®]
METALISATION[®]
NORTON[®]
PTA[®]
SMARTARC[®]
STELLITE[®]
TAFA[®]/PRAXAIR[®]THERMACH
THERMION[®]
COLOMONOY[®]



BAYSTATE®

Baystate® Plasma Gun

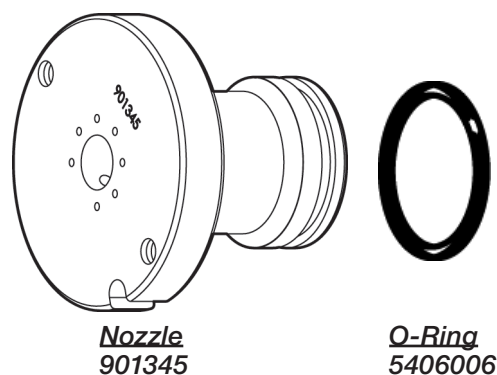
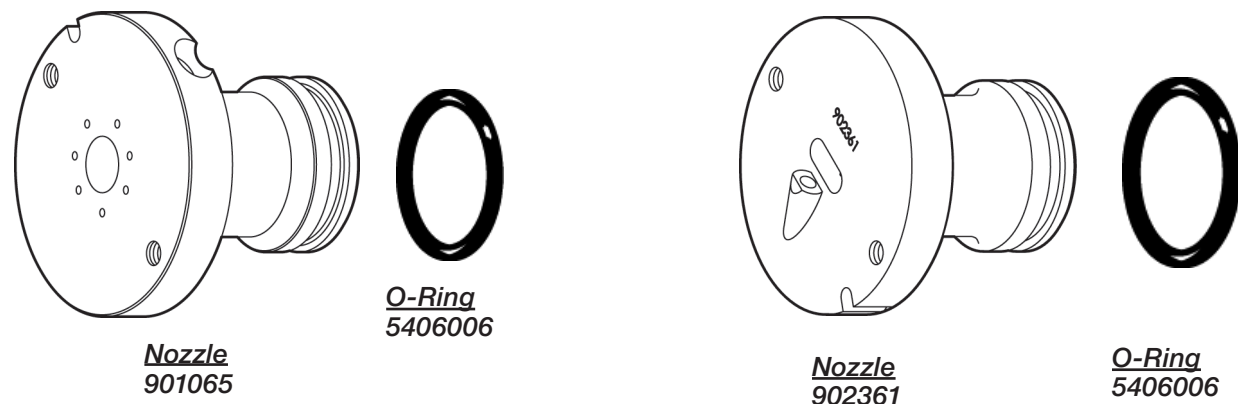

Not Shown
902352-1 Cathode

EUTECTIC®

Eutectic® Terojet®

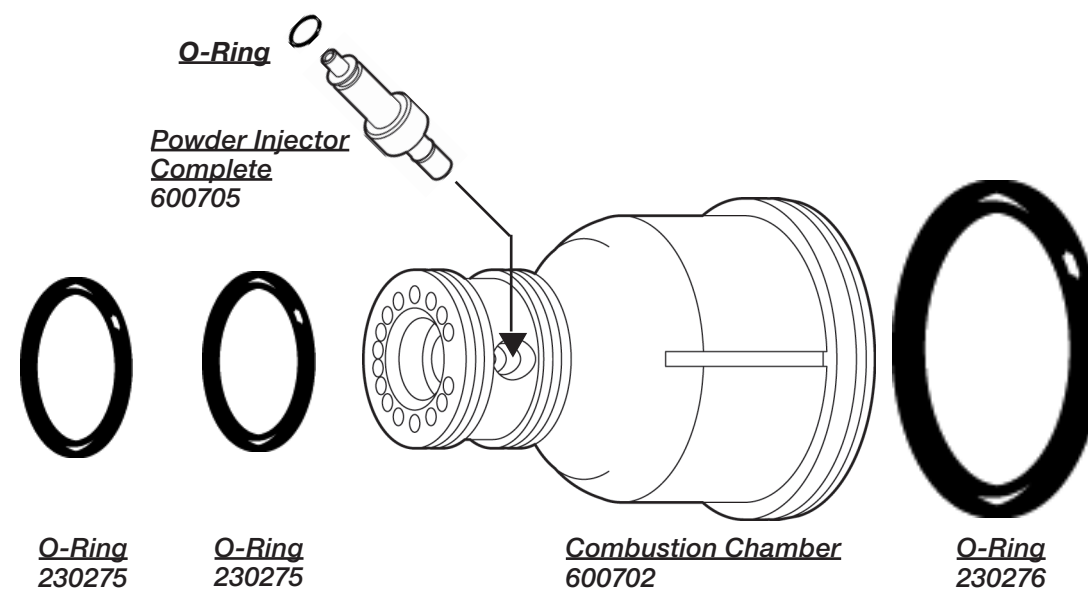
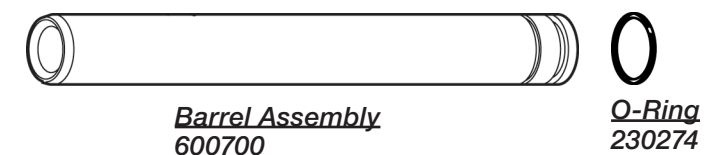

PG Systems

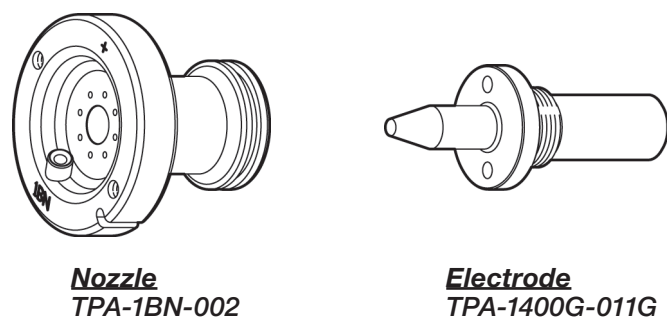

THERMAL

THERMAL

Eutectic® Terodyn®

GTV® K2®

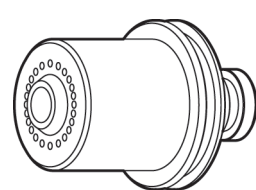

Nozzle
RL200M

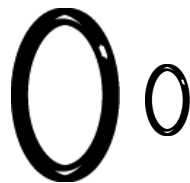

O-Ring Pkg.
84355

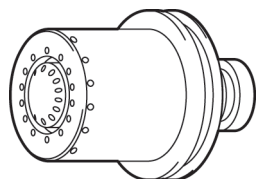

Nozzle
RL210W

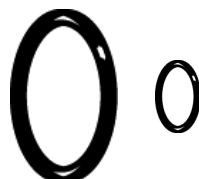

O-Ring Pkg.
84355

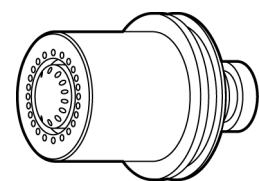

Nozzle
RL210M

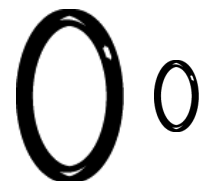

O-Ring Pkg.
84355

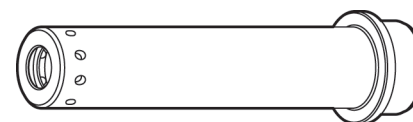

Intermediate Section
780.120-150

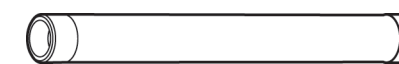

Expansion Nozzle
780.150-150

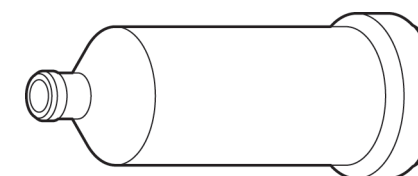

Combustion Chamber
780.160

THERMAL

THERMAL

Metco® Diamond Jet

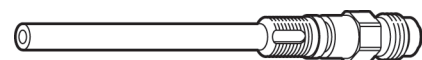

Powder Feed Hose Fitting
DJ10

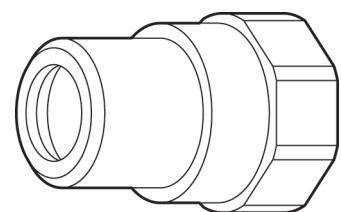

Air Cap Body
DJ2721

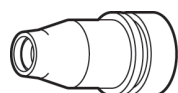

C Shell
DJ17-C

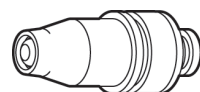

Nozzle Assy
DJ7-7C

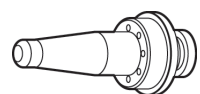

#7 Insert Propane
DJ18-7

Not Shown
DJ61 Gun Body O-Ring
CV-8L Check Valve
CV-7R Check Valve

Propylene

Not Shown
DJ6 Nozzle Nut

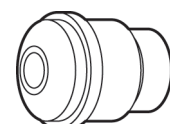

Air Cap
DJ3-2

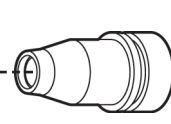

Nozzle Shell
DJ17-A



O-Ring
DJ108

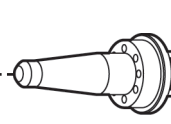

Nozzle Insert
DJ18-3

O-Ring
DJ109

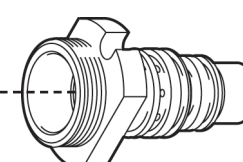

Distribution Plug
DJ2-2

O-Ring
DJ108

O-Ring
DJ77 x2

Powder Injector
DJ8-3

O-Ring
DJ109 x2

Propane

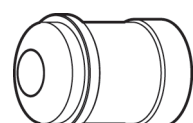

Air Cap
MVG4

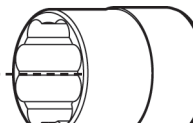

Nozzle Nut
MVG7

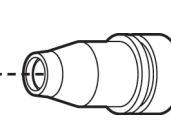

Nozzle Shell
MVG17-A



O-Ring
DJ108

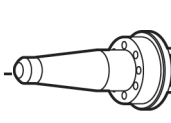

Nozzle Insert
MVG18-3

O-Ring
DJ109

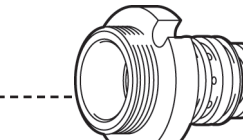

Distribution Plug
MVG2-4

O-Ring
DJ108

O-Ring
DJ77 x2

Powder Injector
MVG8-3A

O-Ring
DJ109 x2

Propylene

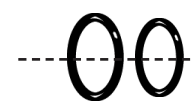

O-Ring
DJ77

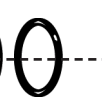

O-Ring
DJ2611

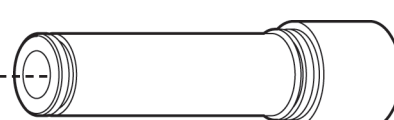

Extended Air Cap
DJ2701
DJ2702

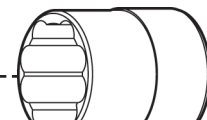

Nozzle Nut
DJ2706

O-Ring
DJ558

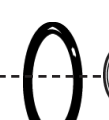

Nozzle
DJ7-9

O-Ring
DJ63

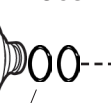

O-Ring
DJ62



Distribution Plug
DJ2-9

O-Ring
DJ108

O-Ring
DJ77 x2

Powder Injector
DJ8-9

O-Ring
DJ109 x2

Hydrogen



O-Ring
DJ77

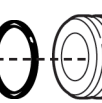

O-Ring
DJ2611

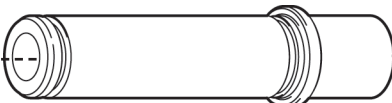

Extended Air Cap
DJ2603

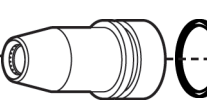

Nozzle Shell
DJ17-8

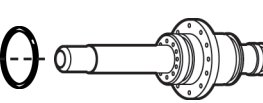

Nozzle Inserts
DJ18-8

O-Ring
DJ62

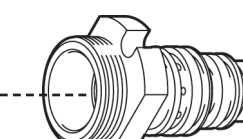

Distribution Plug
DJ2-8

O-Ring
DJ108

O-Ring
DJ77 x2

Powder Injector
DJ8-8

O-Ring
DJ109 x2

Not Shown
DJ2606 Nozzle Nut

THERMAL

THERMAL

Metco® 10E

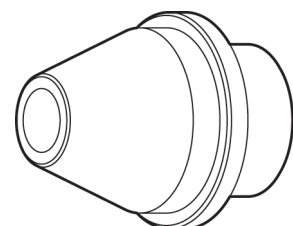

Air Cap
10E3-EC

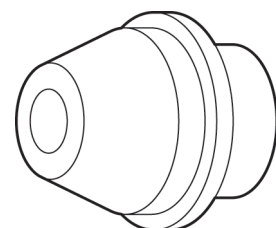

Air Cap
10E3-C

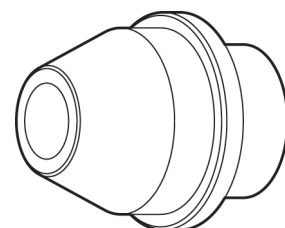

Air Cap
10E3-EA

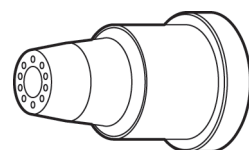

Nozzle
10E7A-1/8

Metco® 11E



O-Ring
11E108

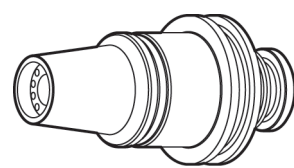

Nozzle
11E7-15



O-Ring
11E109

American Torch Tip Company is in no way affiliated with the above-named original equipment manufacturer(s) ("OEM"). References to the above-named machines, torches, and numbers are for your reference only. Most parts advertised for sale are made by or for American Torch Tip, and other parts as indicated, are original parts manufactured by above-named OEM and are simply being re-sold by American Torch Tip. Footnotes: * = OEM; # = American Torch Tip is licensed to make and sell this part by named manufacturer; ATTC and ATT suffix = This part is an original American Torch Tip design and is not manufactured identical to the OEM design; © indicates a registered trademark, trade name, or product name of the above-named company. PHD®, PHDX™, Lightning®, Waltec™, Integra™, Lasertec Laser Division of American Torch Tip®, Multi-Use™ and ProMix™ are trademarks owned by American Torch Tip Company. © Copyright 2017, American Torch Tip Company

Metco® 14E

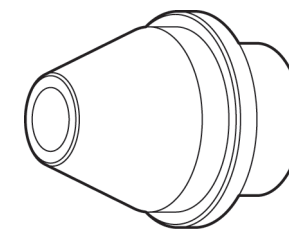

Air Cap
14E3-EC

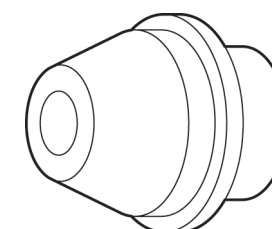

Air Cap
14E3-C

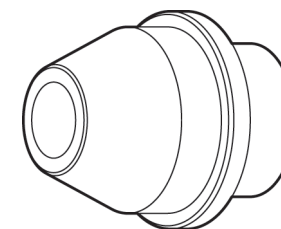

Air Cap
14E3-EA



O-Ring
14E108

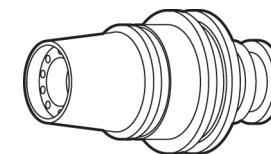

Nozzle
14E7-43



O-Ring
14E109



O-Ring
14E108

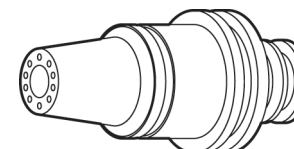

Nozzle
14E7-49



O-Ring
14E109



O-Ring
14E108

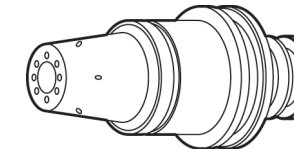

Nozzle
14E7-26



O-Ring
14E109



O-Ring
14E108

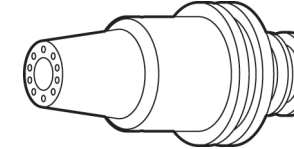

Nozzle
14E7-48



O-Ring
14E109

Not Shown
14E7-45 Non-load Nozzle

American Torch Tip Company is in no way affiliated with the above-named original equipment manufacturer(s) ("OEM"). References to the above-named machines, torches, and numbers are for your reference only. Most parts advertised for sale are made by or for American Torch Tip, and other parts as indicated, are original parts manufactured by above-named OEM and are simply being re-sold by American Torch Tip. Footnotes: * = OEM; # = American Torch Tip is licensed to make and sell this part by named manufacturer; ATTC and ATT suffix = This part is an original American Torch Tip design and is not manufactured identical to the OEM design; © indicates a registered trademark, trade name, or product name of the above-named company. PHD®, PHDX™, Lightning®, Waltec™, Integra™, Lasertec Laser Division of American Torch Tip®, Multi-Use™ and ProMix™ are trademarks owned by American Torch Tip Company. © Copyright 2017, American Torch Tip Company

THERMAL

THERMAL

Metco® 12E

Metco® 3MB

THERMAL

THERMAL

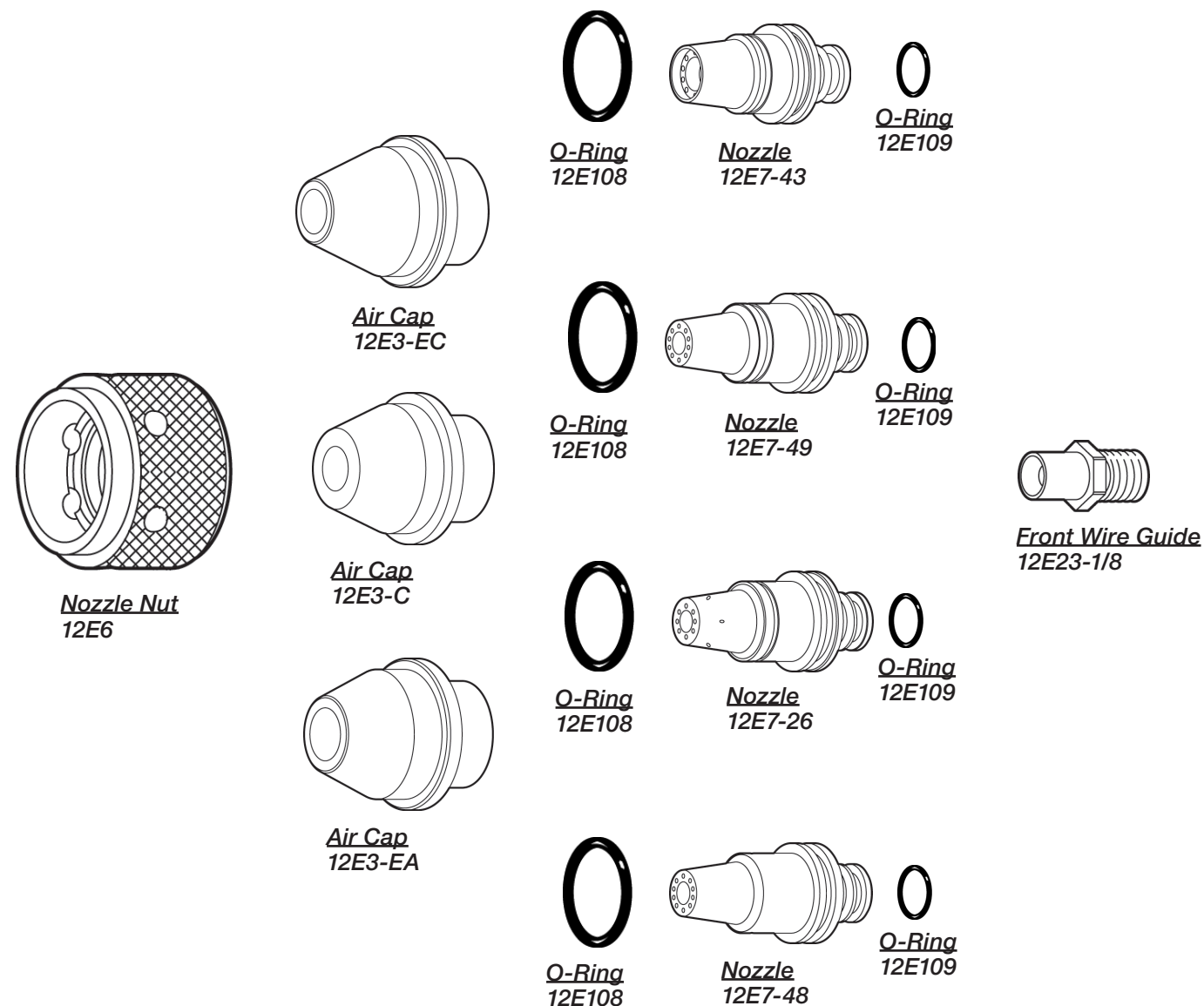

Not Shown
 12E26 Nozzle Nut
 12E-200-2 Siphon Plug Assy

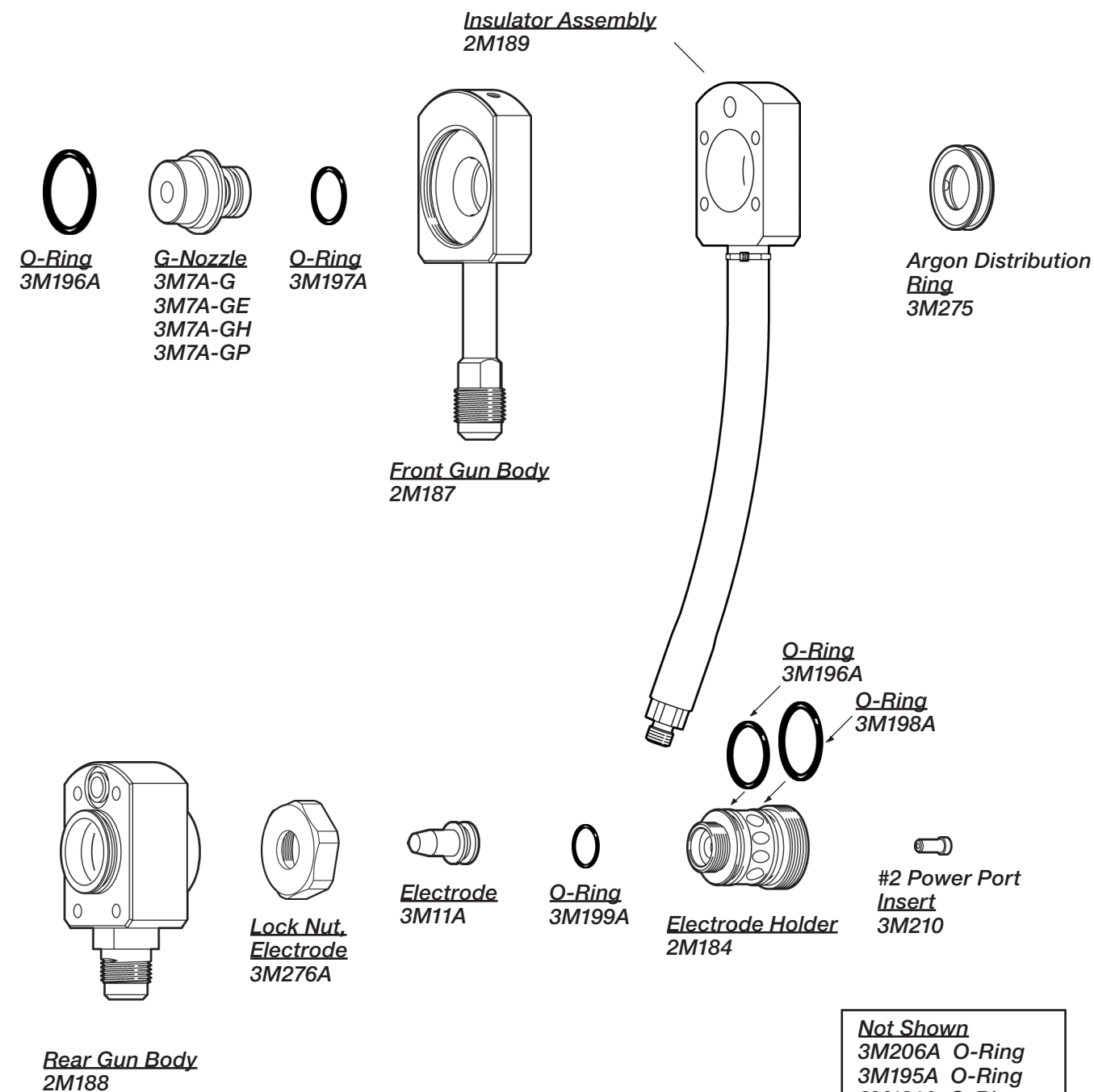

Not Shown
 3M206A O-Ring
 3M195A O-Ring
 3M181A O-Ring
 3M11F Electrode

Metco® 3MBII

Metco® 7MB

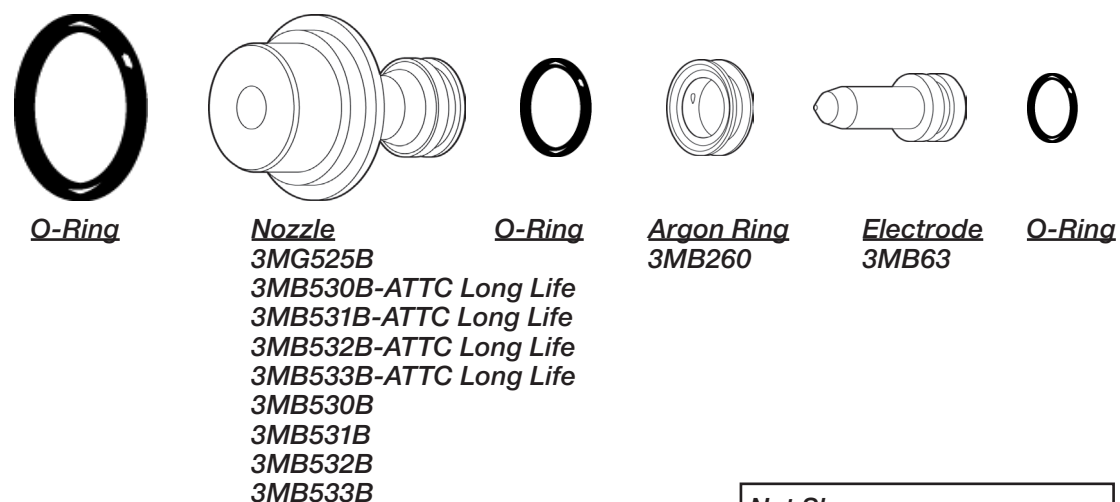

Not Shown
3MB187 Front Gun Body
3MB189 Insulator Assembly

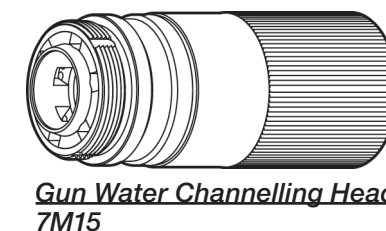
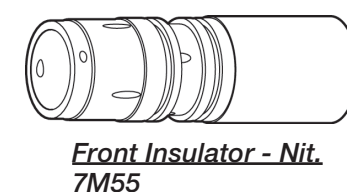
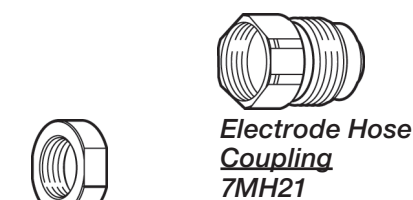
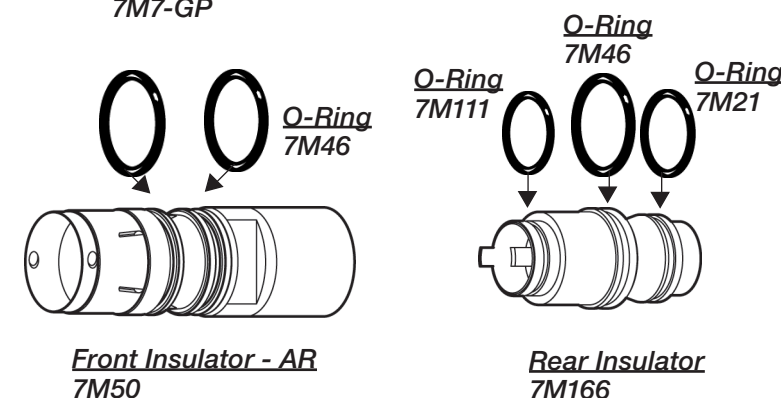
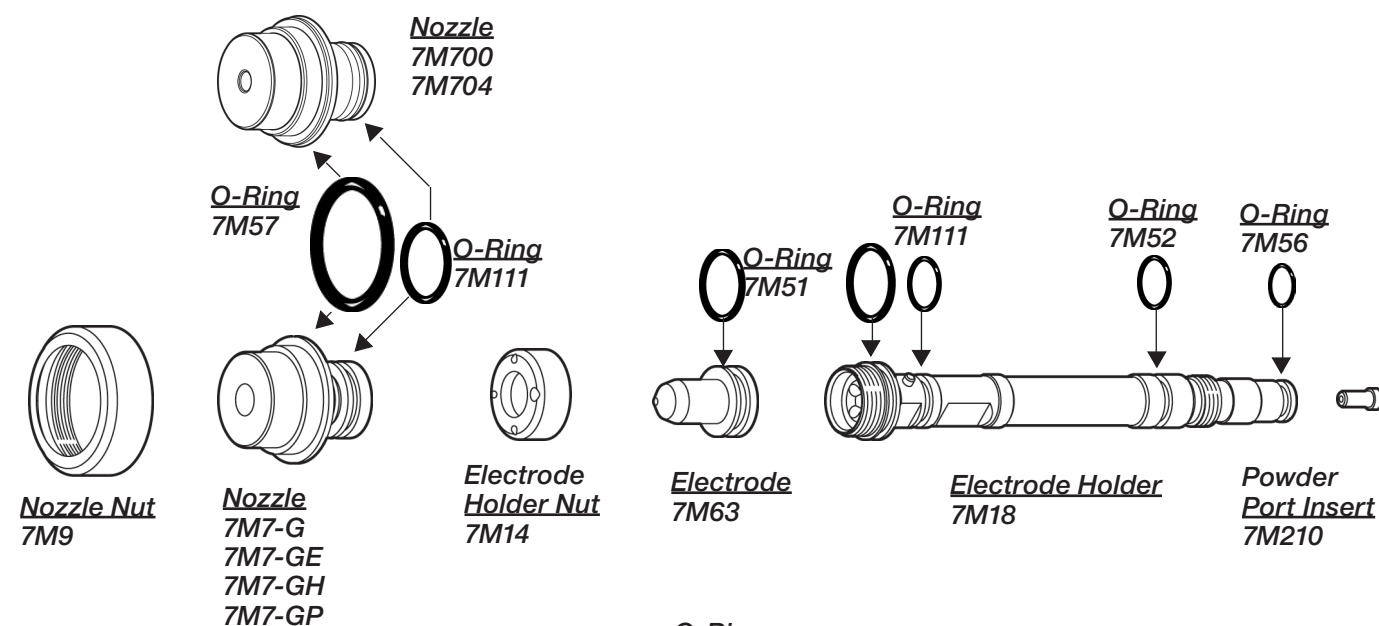

Metco® 3MBT

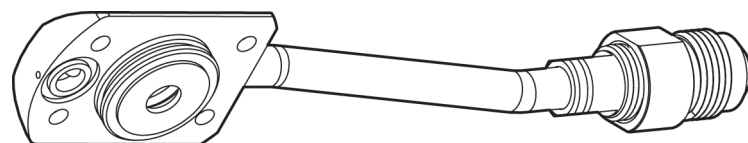

Gun Body Rear 30°
3MBT-392

THERMAL

THERMAL

Metco® 9MB

Metco® 10MB

Not Shown
 9MB50 Front Insulator Assy.
 9MB297 O-Ring
 9MB852 Wrench

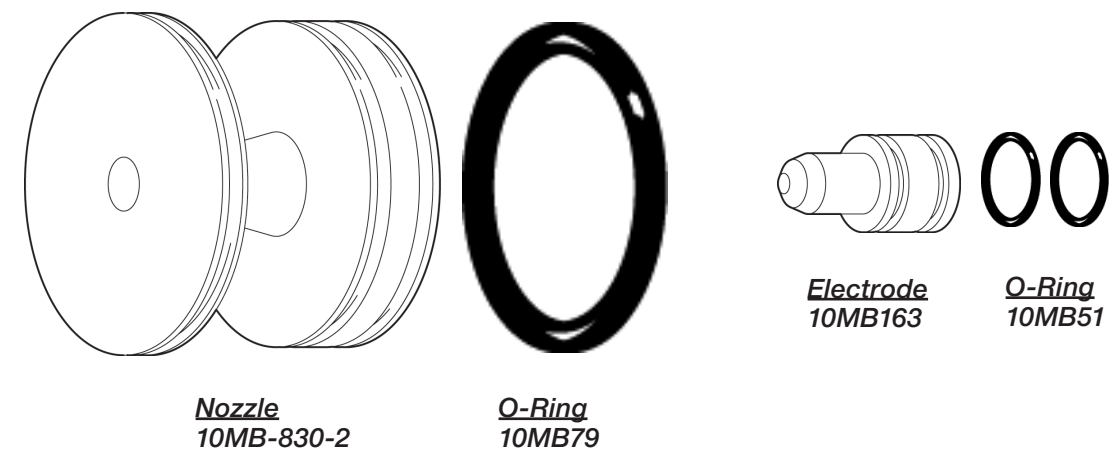
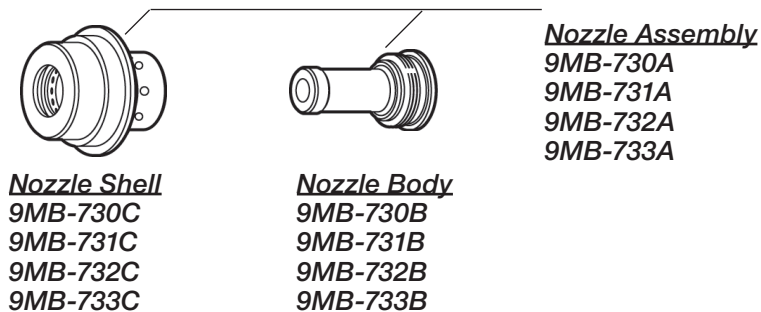

THERMAL

THERMAL

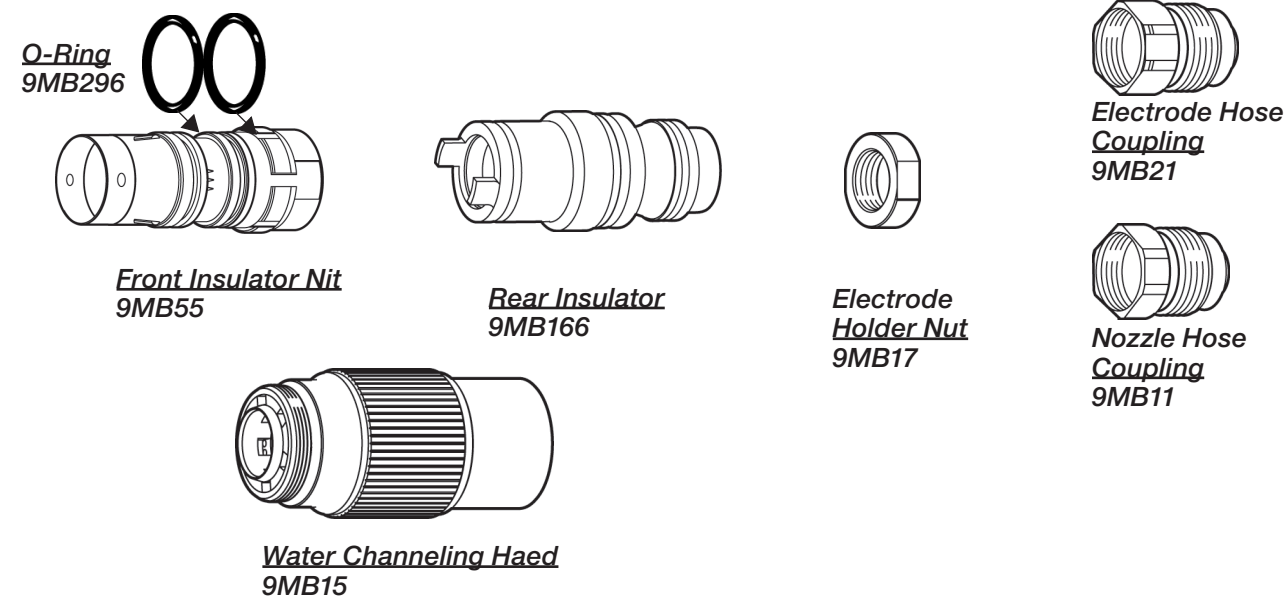
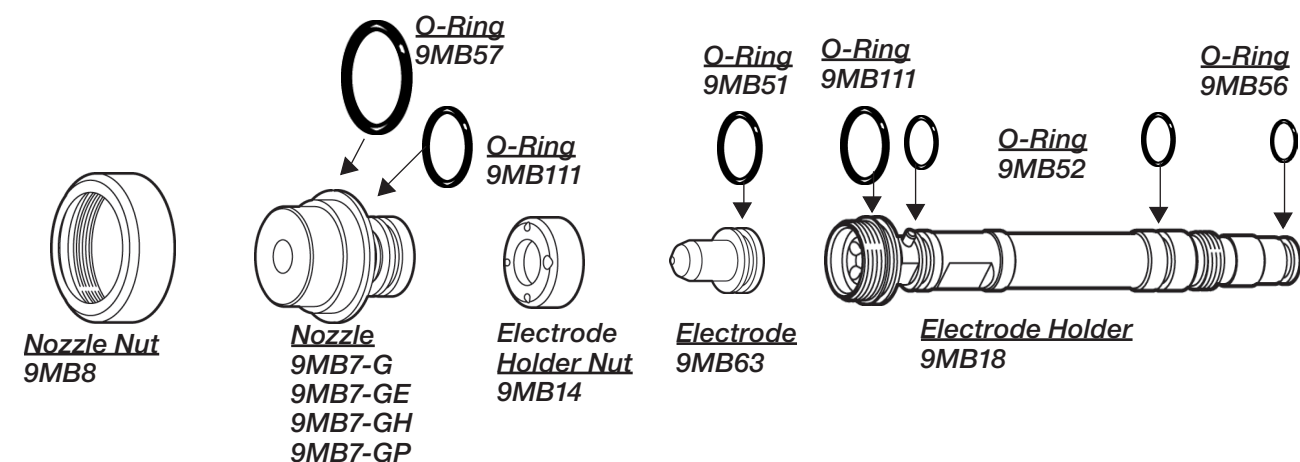

Metco® 11MB

Metco® 2RG

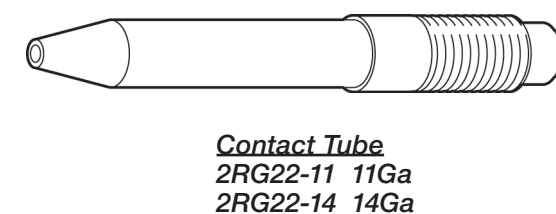
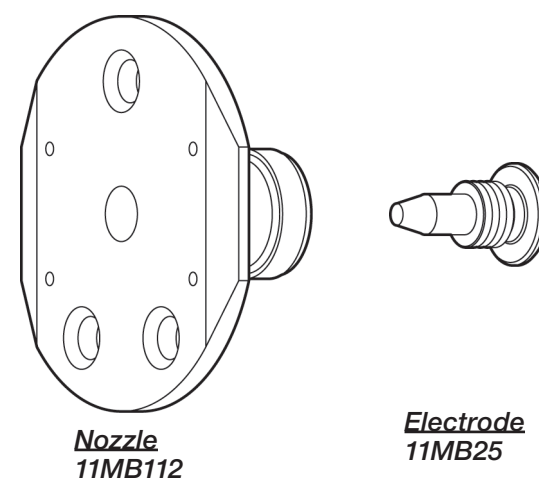

Metco® 5P

Metco® 6P

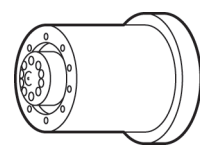

Nozzle
5P7-G

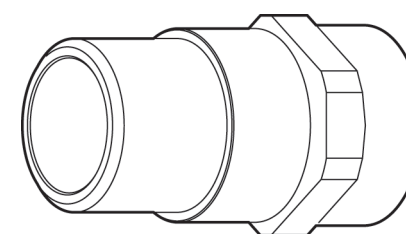

Air Cap Body
6P117

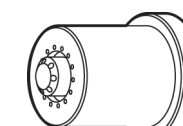

Nozzle
6P7A-D

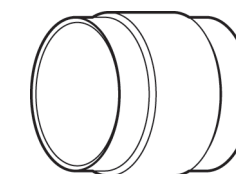

Sleeve
6P82

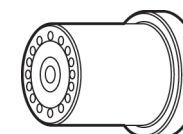

Nozzle
6P7A-M

THERMAL

THERMAL

Metco® 5P11

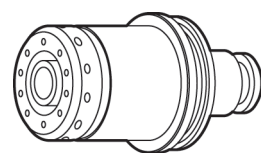

Nozzle
5P7B-F



O-Ring
5P108



O-Ring
5P107



**Baffle
Brass**
5P518

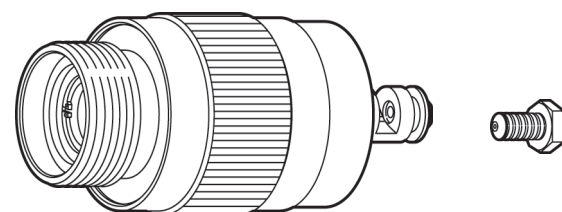

Siphon Plug Assy.
5P585

Screw
5P520



Retaining Ring
6P84



Baffle
6P83, Brass

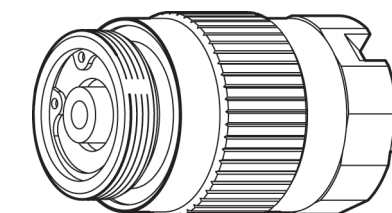

Siphon Plug
6P200

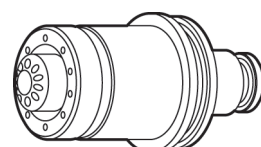

Nozzle
5P7B-G



O-Ring
5P108



O-Ring
5P107

Not Shown
5P84 Baffle Retaining Ring
5P515 O-Ring, Aspirator
5P516 O-Ring, Siphon Plug
5P519 Sleeve

Metco® 6P11

Metco® 6RG

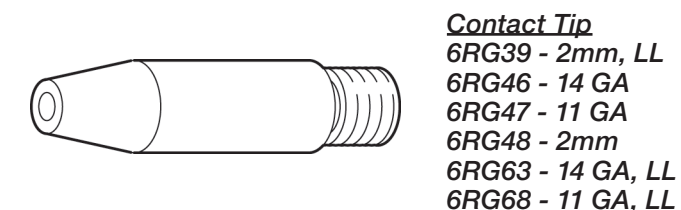
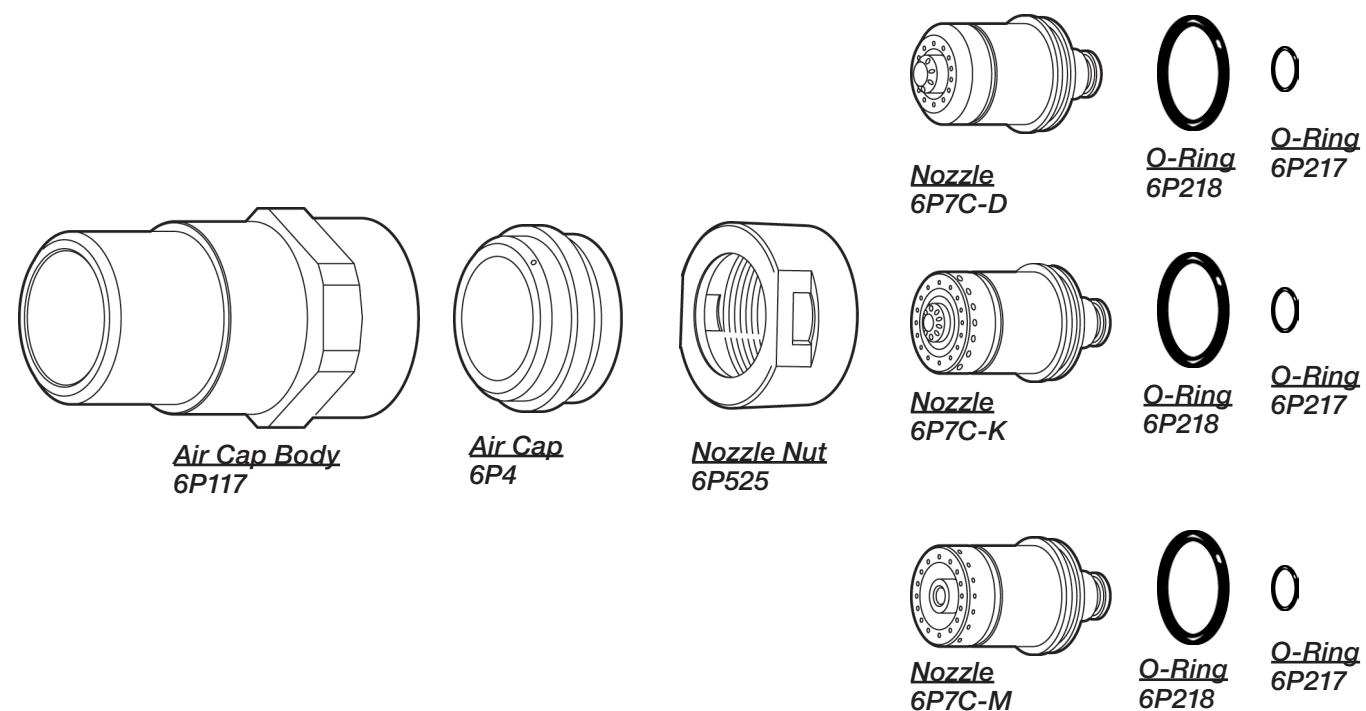

Metco® F4

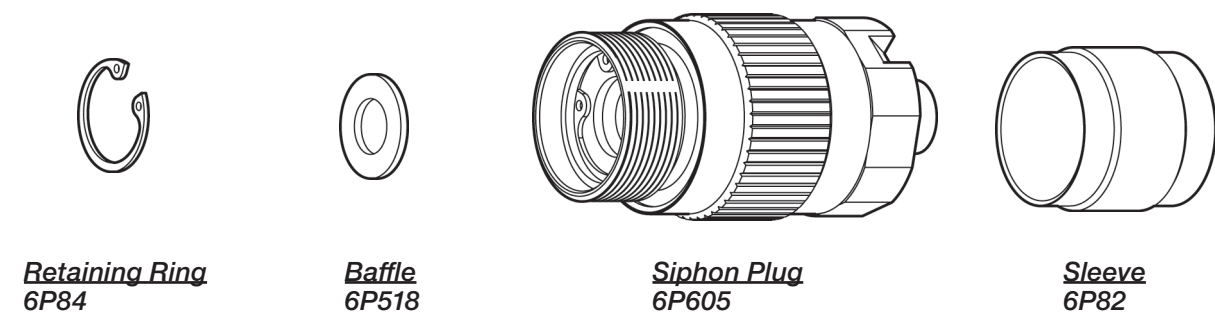
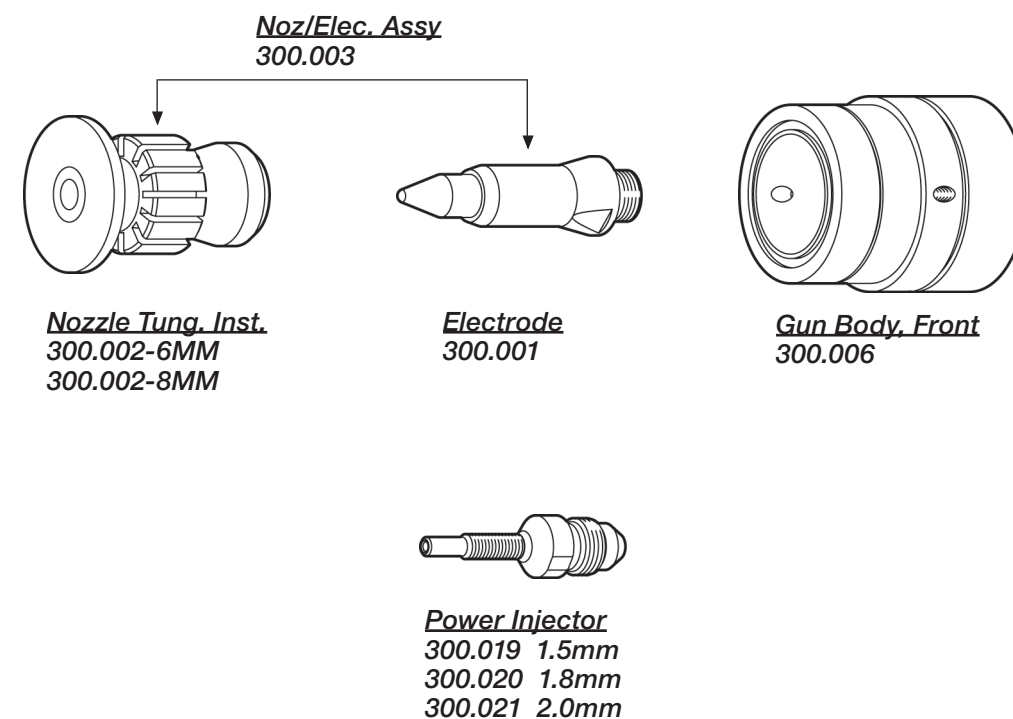

THERMAL

THERMAL

Metco® F100

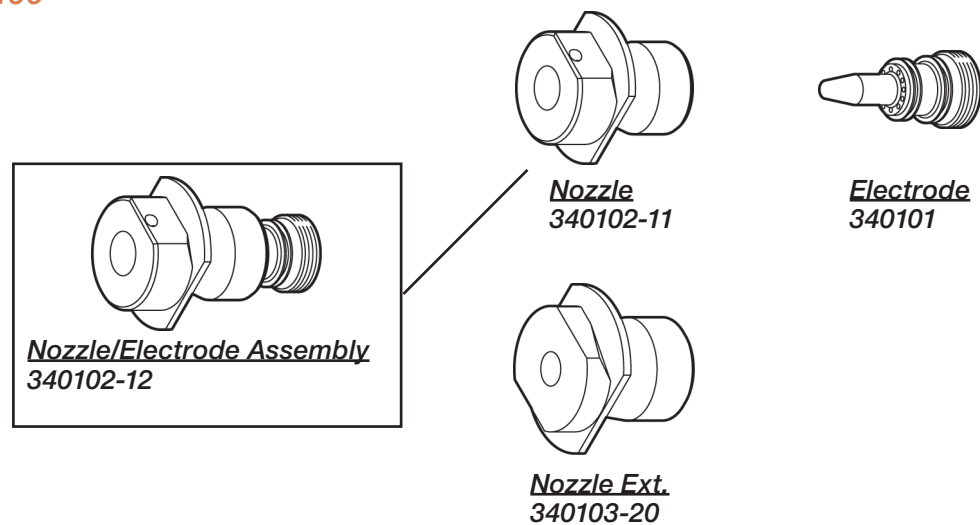

THERMAL

Metco® 03CA

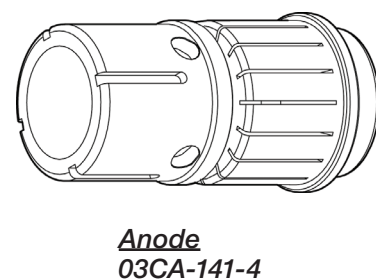

Smartarc®

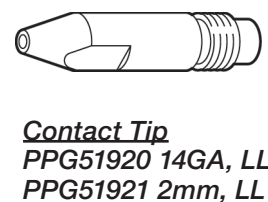

METALISATION®/NORTON®

Metalisation® Arcspray 140



Norton® Rokide

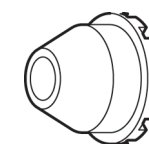

Air Cap
773.3282.B 5/16"
773.3281.B 1/4", 3/16"



Nozzle
773.3279.B 1/4"
773.3280.B 5/16"
773.3287.B 3/16"

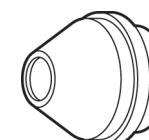

Air Cap
5000258 1/4"

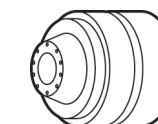

Nozzle
500103A 1/4"

THERMAL

Not Shown
773.3051.B Main Body Air Cap
773.3058.B Mixing Head

PTA/ STELLITE®

Stellite® PTA

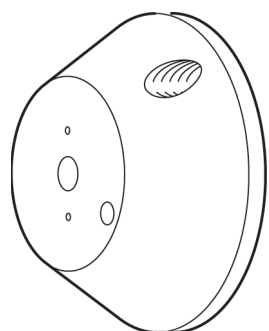

Power Spray Orifice
562328

Stellite® PTA 600



Nozzle
963822-3/16
963824-1/8

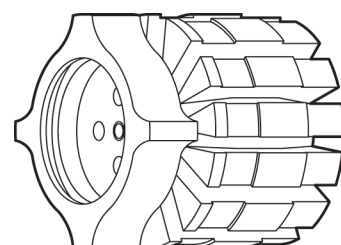

Combustion Head
972494 .080 OEM
972569 .052 OEM

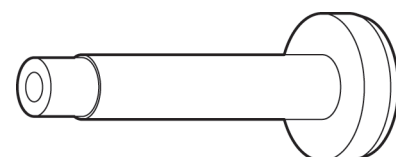

Nozzle

Part #	Length	I.D.
972935	6.00"	1/4
972849	6.00"	5/16
972950	9.00"	1/4
972521	9.00"	5/16



Combustion Chamber
972495

STELLITE®

Stellite® Micostar Starweld HPH 150



Electrode
15191



Electrode
963572



Electrode
966545



Powder Nozzle#4
966556



Plasma Nozzle
966554

Not Shown
966565 Shield Gas Nozzle

Tafa®/Praxair® BP400



Wire Guide
5000391 11 gauge
5000392 14 gauge



Air Cap
5000019A



Wire Guide
5000981 14 gauge

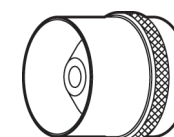

High Velocity Air Cap
5004734

Not Shown
5005233-3 Coaxial Power Cable
5005233-10 Coaxial Cable 10' Power
5005233-15 Coaxial Cable 15' Power

THERMAL

THERMAL

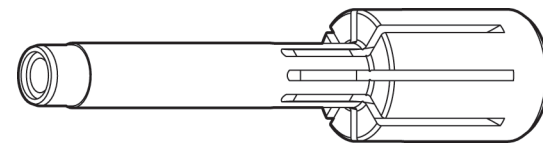

Nozzle
5003411 0mm

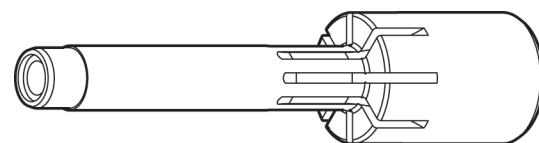

Nozzle
5003218 22mm

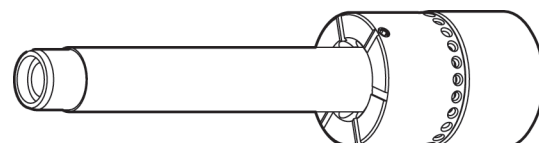

Nozzle
5003219 12mm

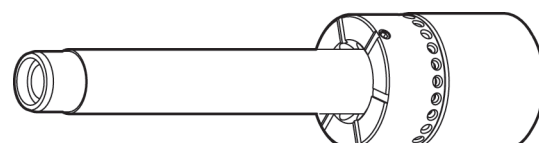

Nozzle
5003185 19mm

Not Shown
500217 O-Ring Kit

THERMAL

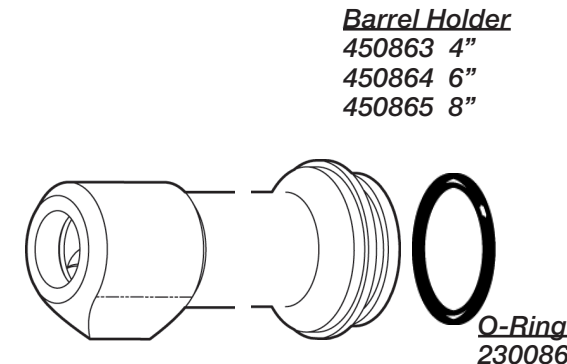

Barrel Holder
450863 4"
450864 6"
450865 8"

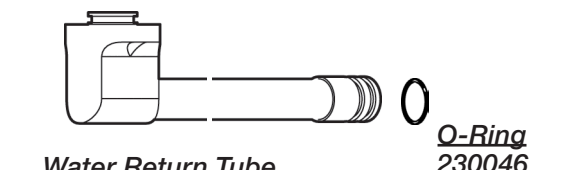

Water Return Tube
450869 4"
450870 6"
450871 8"



Water Baffle
450936

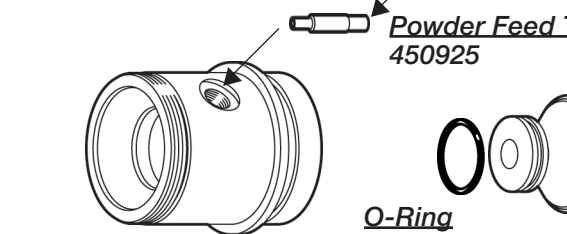

Ferrel
210042

Fitting Powder Port
620180

Powder Feed Tube
450925



Interconnector
450922

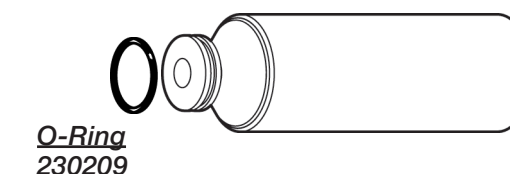

O-Ring
230209

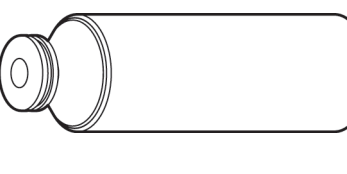

Combustion Chamber
450924

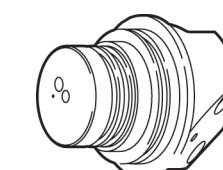

Coaxial Stabilizer
450861



Spark Plug Assy
600408



Coaxial Tube Assy.
600464



Electrode
450875

Not Shown	
200418 Screw	230212 O-Ring
200816 Screw	410112 Check Valve
210010 Adapter	410113 Check Valve
210077 Nipple	450779 Nut
210081 Nipple	600392 Coaxial Stab. Assy.
210145 Adapter	600401 Barrel Assembly 4"
230027 O-Ring	620178C Elbow/Nipple Assy.
230094 O-Ring	

THERMAL

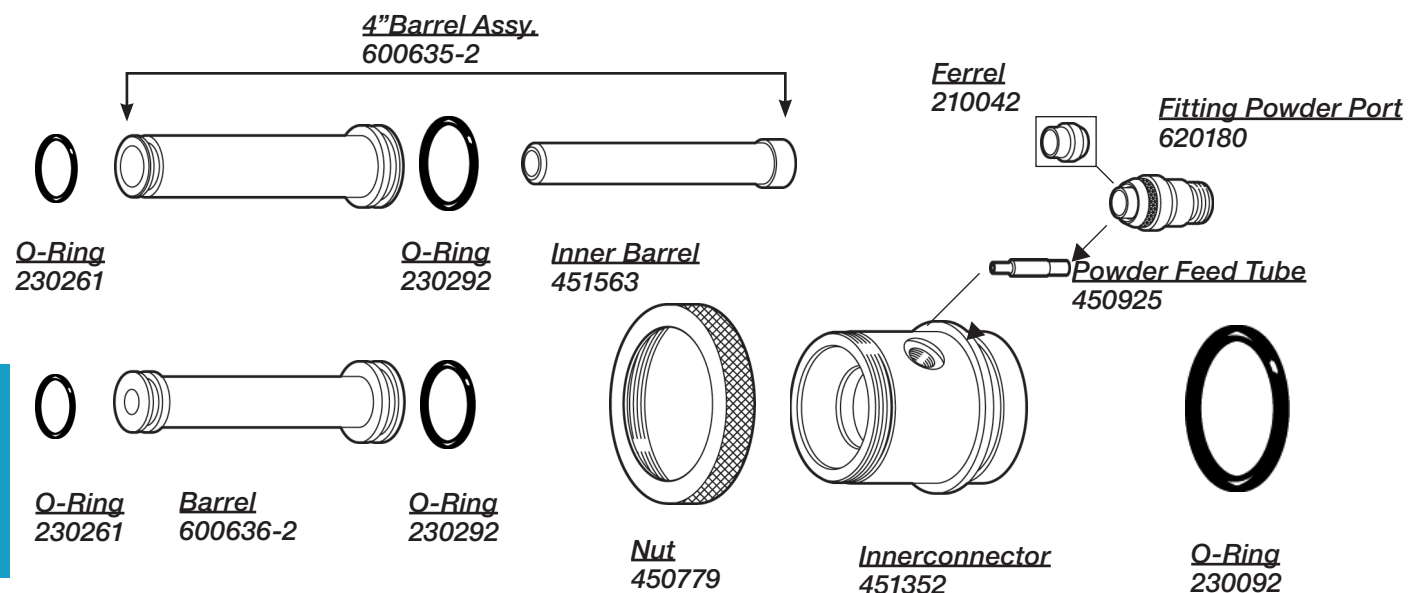

THERMAL

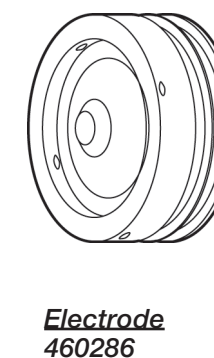
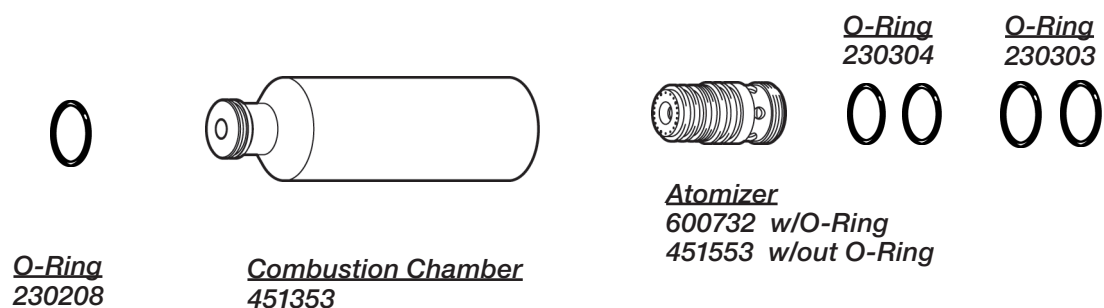

THERMAL

Tafa®Praxair® SG100

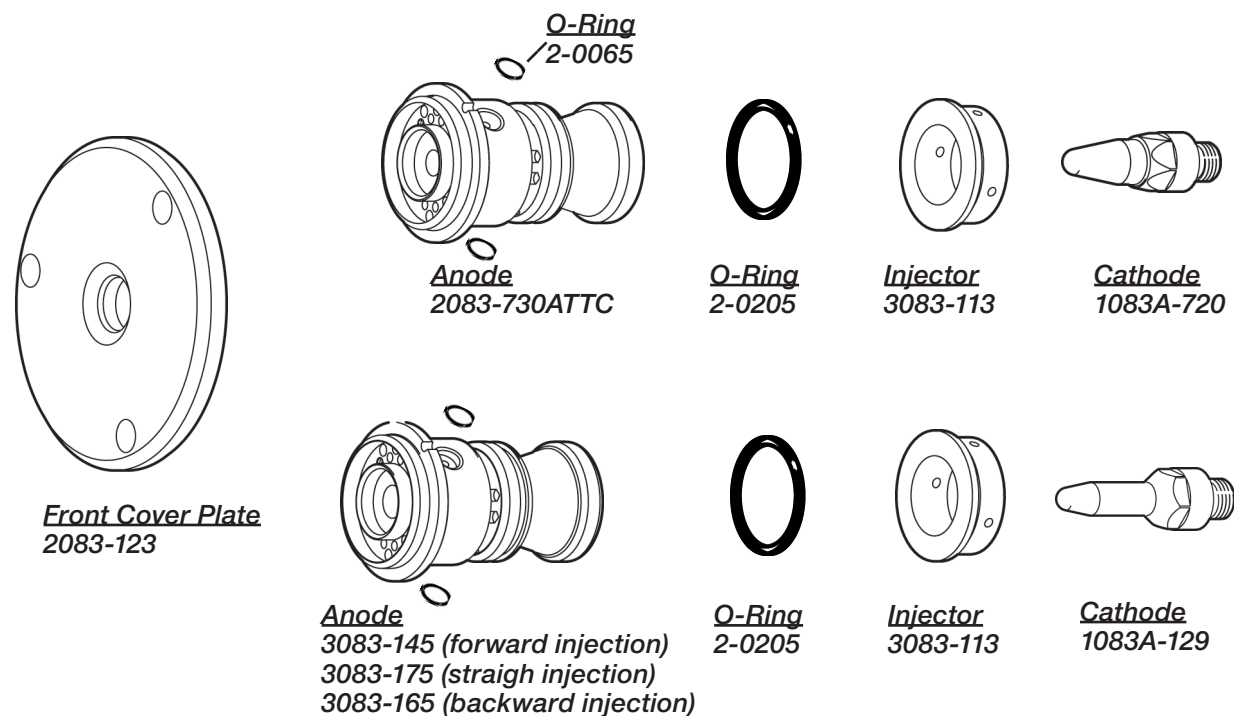

Front Cover Plate
2083-123

Anode
2083-730ATTTC

O-Ring
2-0205

Injector
3083-113

Cathode
1083A-720

Anode
3083-145 (forward injection)
3083-175 (straigh injection)
3083-165 (backward injection)

O-Ring
2-0205

Injector
3083-113

Cathode
1083A-129

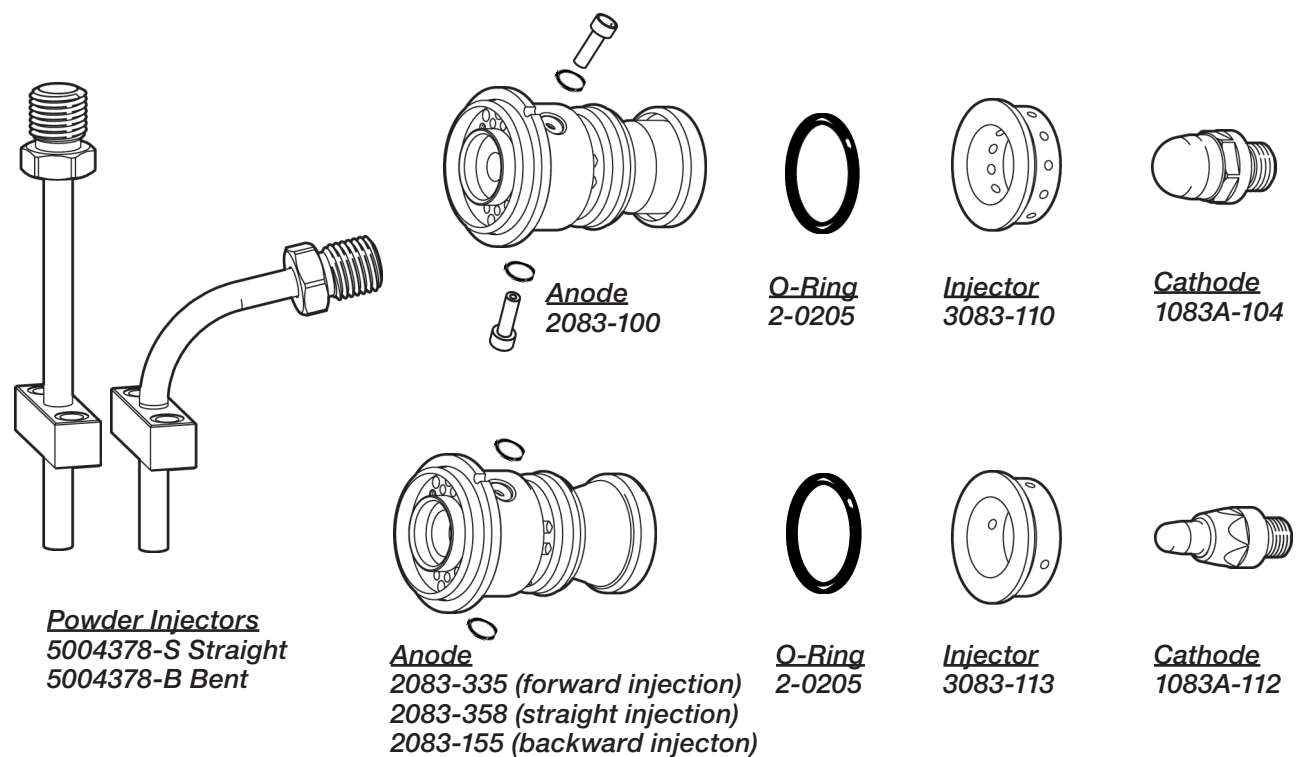

Powder Injectors
5004378-S Straight
5004378-B Bent

Anode
2083-100

O-Ring
2-0205

Injector
3083-110

Cathode
1083A-104

Anode
2083-335 (forward injection)
2083-358 (straight injection)
2083-155 (backward injection)

O-Ring
2-0205

Injector
3083-113

Cathode
1083A-112

Tafa®Praxair® 2086A/SG100 Mini Gun

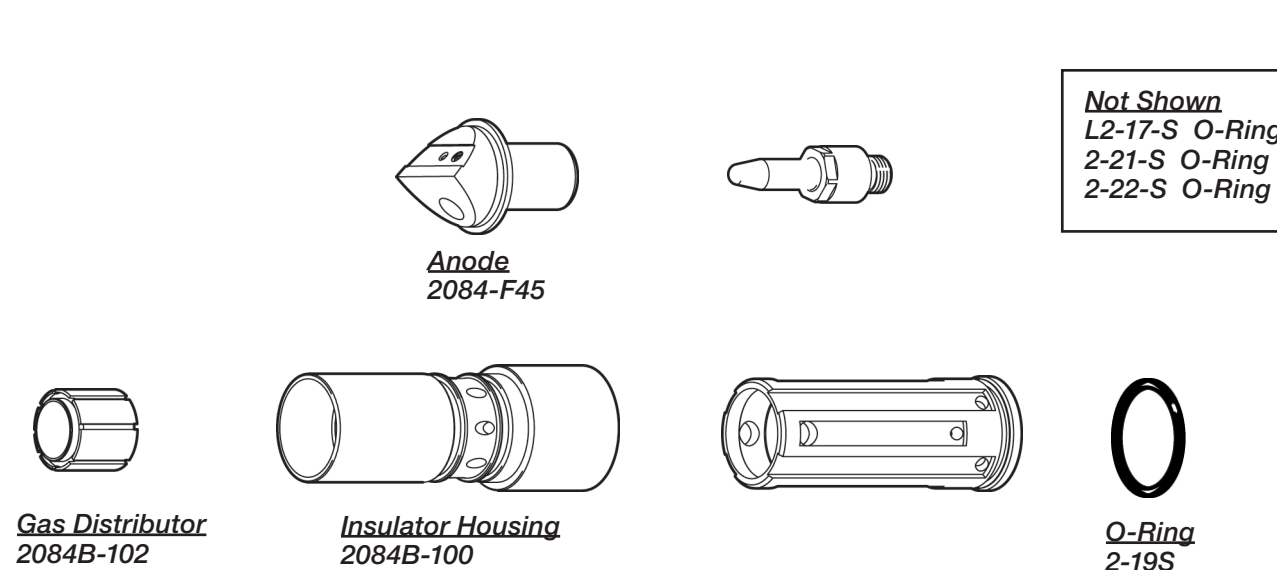

Anode
2084-F45

Gas Distributor
2084B-102

Insulator Housing
2084B-100

O-Ring
2-19S

Not Shown
L2-17-S O-Ring
2-21-S O-Ring
2-22-S O-Ring

Tafa®Praxair® 2700 Mini Gun

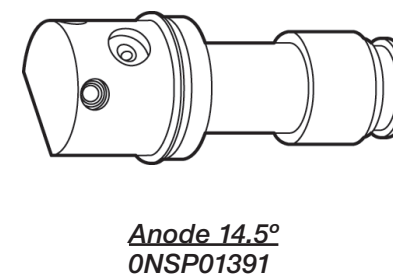

Anode 14.5°
ONSP01391

Tafa®Praxair® SG200



Cathode
1230A-401

THERMAL

THERMAL

Tafa®Praxair® 88XX

Retaining Nut
600047

Cap
450031 Blue
450032 Gold
450033 Green
450034 Red

Nozzle Cap
450729

Wire Drive Roller
450010
600250

Alignment Housing
600398

Positioner

Long Slot Nozzle
450027

Short Slot Nozzle
620023

Short Cross Slot
620047

Terminal
450024 - Screw
450039 - Short
450040 - Long
450048 - Top

Complete Assy, Long
600136

Complete Asst. Short
600038

Not Shown
220105 Teflon Conduit
450979 Contact Tube
620074 Arc Jet Noz Pos

Contact Tip
8860-125

For 8860 Gun

- Contact Tip**
450042 - 1/16
450043 - 2 mm
450044 - 1/16 Al
450045 - 2 Al
450289 - 1/16 (I.D.)
450303 - .045
450458 - 1/16 LL
450491 - 1/16 LL, Al
450604 2mm LL
- Contact Tip w/2start thread**
450067 1/16 Brass
450068 1/16 LL
- Contact Tube**
450021 88XX
450859 9000
450022 1/8 (2 start)
450023 1/16 (2 start)
- Conduits Ends**
450683-1 Long
450683 Short
- Long Rear Wire Guide**
600159
- Short Rear Wire Guide**
600158

Power Lead End Fitting Gun End
450302

Thermach®

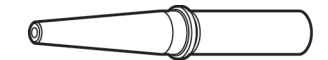

Wire Guide
840000308 14Ga

Thermion®

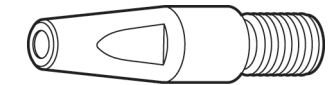

Contact Tip
50065-1/8
50065-1/16
50065-3/16

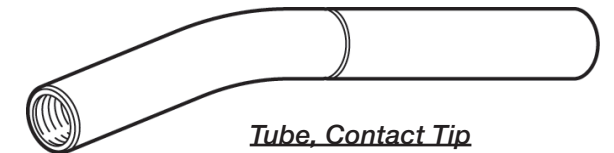

Tube, Contact Tip
50076

Wall Colmonoy®

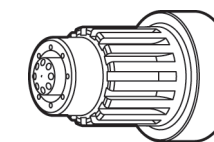

Nozzle
J-3B
J-3C



Notes

THERMAL

American Torch Tip Company is in no way affiliated with the above-named original equipment manufacturer(s) ("OEM"). References to the above-named machines, torches, and numbers are for your reference only. Most parts advertised for sale are made by or for American Torch Tip, and other parts as indicated, are original parts manufactured by above-named OEM and are simply being re-sold by American Torch Tip. Footnotes: * = OEM; # = American Torch Tip is licensed to make and sell this part by named manufacturer; ATTC and ATT suffix = This part is an original American Torch Tip design and is not manufactured identical to the OEM design; © indicates a registered trademark, trade name, or product name of the above-named company. PHD®, PHDX™, Lightning®, Waltec™, Integra™, Lasertec Laser Division of American Torch Tip®, Multi-Use™ and ProMix™ are trademarks owned by American Torch Tip Company. © Copyright 2017, American Torch Tip Company