

PLASMA CONSUMABLES



Suitable for use with
HYPERTHERM[®]

HPR260XD[®] / **HPR400XD**[®]

30 - 130 AMP CONSUMABLES



(Typical setup shown. Parts for your application may look slightly different)

Amp	Shield Cap	Shield	Nozzle Retaining Cap	Nozzle	Swirl Ring	Electrode	Water Tube
Mild Steel							
30	220747ATTC	220194ATTC	220754	220193ATTC	220180	220192ATT	220340ATTC
50	220747ATTC	220555ATTC	220754	220554ATTC	220553	220552ATT	220340ATTC
80	220747ATTC	220189ATTC	220756	220188ATTC	220179	220187ATT 420566ATTC (CleanCut™)	220340ATTC
130	220747ATTC	220183ATTC	220756	220182ATTC	220179	220181ATT 220665ATTC (CleanCut™)	220340ATTC
Stainless Steel							
45	220747ATTC	220202	220755	220201ATTC	220180	220308ATT	220340ATTC
80	220747ATTC	220338ATTC	220755	220337ATTC	220179	220339ATT	220340ATTC
130	220747ATTC	220198ATTC	220755 (H35) 220756 (N ₂)	220197ATTC	220179	220307ATT	220340ATTC
Aluminum							
45	220747ATTC	220202	220756	220201ATTC	220180	220308ATT	220340ATTC
130	220747ATTC	220198ATTC	220755 (H35) 220756 (Air)	220197ATTC	220179	220307ATT (H35) 220181ATT (Air)	220340ATTC

130 - 400 AMP BEVELING CONSUMABLES

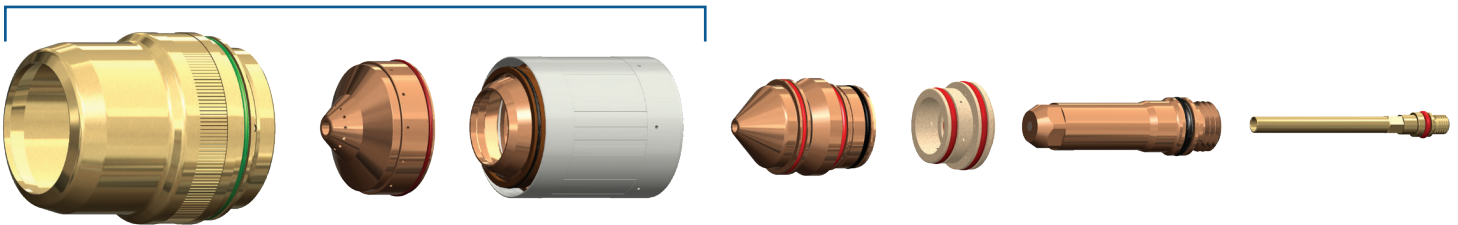

† Shield Cap, Shield and Nozzle Retaining Cap must be used in combination for proper operation.

(Typical setup shown. Parts for your application may look slightly different)

Amp	† Shield Cap	† Shield	† Nozzle Retaining Cap	Nozzle	Swirl Ring	Electrode	Water Tube
Mild Steel - Bevel							
130	90-0637	90-0742	220740*	90-0646	90-0179	90-0649	90-0700
200	90-0637	90-0658	220845*	90-0659	90-0353	90-0662	90-0700
260	90-0637	90-0741	220740*	90-0542	90-0436	90-0541	90-0571
400	90-4000	90-4002	90-4001	220632ATTC	220631*	220629ATT	220571ATTC
Stainless Steel - Bevel							
130	220637*	220738*	220739*	220656ATTC	220179	220606ATT	220571ATTC
260	220637*	220738*	220739*	220607ATTC	220405	220606ATT	220700ATTC
400	220657*	220707*	220712*	220708ATTC	220405	220709ATT	220571ATTC

200 - 400 AMP CONSUMABLES

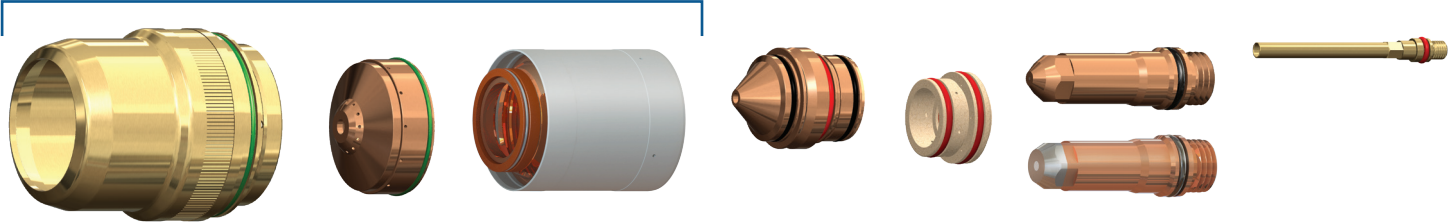

† Shield Cap, Shield and Nozzle Retaining Cap must be used in combination for proper operation.

(Typical setup shown. Parts for your application may look slightly different)

Amp	† Shield Cap	† Shield	† Nozzle Retaining Cap	Nozzle	Swirl Ring	Electrode	Water Tube
Mild Steel							
200	90-4000	90-2002	90-2601	220354ATTC	220353	220352ATT 220666ATTC (CleanCut™)	220340ATTC
260	90-4000	90-2602	90-2601	220439ATTC	220436	220435ATT 220668ATTC (CleanCut™)	220340ATTC
400	90-4000	90-4002	90-4001	220632ATTC	220631*	220629ATT 420530ATTC (CleanCut™)	220571ATTC
Stainless Steel							
200	220637*	220762*	220758*	220343ATTC	220342	220307ATT	220340ATTC
260	220637*	220763*	220758*	220406ATTC	220405	220307ATT	220340ATTC
400	220637*	220707*	220712*	220708ATTC	220405	220709ATT	220571ATTC
Aluminum							
200	220637*	220762*	220759*	220346ATTC	220342	220307ATT	220340ATTC
260	220637*	220763*	220758*	220406ATTC	220405	220307ATT	220340ATTC
400	220637ATTC	220707ATTC	220712*	220708ATTC	220405	220709ATT	220571ATTC

CLEANCUT™ TECHNOLOGY

Upgrade Your Consumables

CleanCut™'s patented nozzle and electrode allow your consumables to run longer and cut cleaner making for less downtime and post grind clean-up.

Learn more at:
AmericanTorchTip.com/CleanCut



† American Torch Tip Company is in no way affiliated with the above-named manufacturer(s). References to the above-named machines, torches and numbers are for your convenience only. American Torch Tip is not necessarily authorized by the above-named manufacturer(s) to provide replacement parts. Most parts advertised for sale are made by, or for, American Torch Tip Company and other parts, as indicated, are original parts manufactured by the above-named OEM and are simply being resold by American Torch Tip Company. Part numbers followed by an * are manufactured by the respective OEM.

CREATING A BETTER EXPERIENCE



AMERICAN TORCH TIP®

6212 29th Street East, Bradenton, FL
941-753-7557
Sales@attcusa.com
AmericanTorchTip.com

